

## 1.6 INCOMING SUPPLIES – EMERGENCY CONTACTS / PLANS OF SERVICES TO SITE

### 1.6.1 Emergency Contact Details

Service	Company	Contact telephone number
ELECTRICITY SUPPLY	Electricity North West Ltd	105 / 0800 195 4141
GAS SUPPLY	No Mains Connection	
DATA CABLING	No Data Connection	
WATER SUPPLY	United Utilities	0345 672 3723

### Useful Information in Case of an Emergency

#### What to do if your electricity goes off

Firstly it is important that you check if it is just your electricity that is off or if other people are affected too. If the problem is affecting other people then you can call the Emergency Help Line number for the distribution company where you live. They will advise you on how long it will take to restore supply to your home or business.

Your local electricity distribution company is responsible for the power supply in your area. They are responsible for the wires and cables that connect your home or business to the National Grid. The event of a power cut that affects other houses or business in your area; you should contact your local distribution company.

If yours is the only home or business that is off supply, check your trip switch. If your trip switch is in the off position switch it back on. If it switches off again, one of your electrical appliances may be faulty. To find out if this is the case, switch off all your appliances, set the trip switch to the on position and switch on your appliances one by one. If the trip switch goes off again then you have found the faulty appliance.

#### Gas

**If you smell gas or are worried about gas safety, call the National Gas Emergency Number IMMEDIATELY on 0800 111 999.**

- DON'T smoke
- DON'T use naked flames
- DON'T turn electric switches on or off
- DO turn off the gas supply at the meter
- DO open doors and windows

---

## SECTION 1.6: INCOMING SUPPLIES - PLANS OF SERVICES TO SITE

### 1.6.2 Plans of Services to Site

The Drawings follow in this section:

**Do not allow any future contractors to dig within the building footprint without all statutory Health and Safety precautions and a full survey being undertaken.**

GAC EBM		
Drawing Number	Drawing Title	Rev
P23012-GAC-EX-XX-DR-M-7000	External-Services	A1
P23012-EBM-EX-XX-DR-E-0930	Unit 3 External Services	A1
P23012-EBM-EX-XX-DR-E-0935	Unit 3 Combined M&E External-Services Layout	A1

TABLE 1 - Recommended Colour Coding of Underground Utilities Apparatus  
All depths are from the surface level to the crown of the apparatus

Utility	Duct	Pipe	Cable	Marker Systems	Recommended Footway/Verge	Minimum Carriageway
Electricity HV (High Voltage)	Black or red duct or tile	N/A	Red or black	Yellow with black and red legend or concrete tiles	450-1200mm	750-1200mm
Electricity LV (Low Voltage)	Black or red duct or tile	N/A	Black or red	Yellow with black legend	450mm	600mm
Gas	Yellow	*** See row below		Black legend on PE pipes every linear metre	600mm footway 750mm verge	750mm
		*** PE - up to 2 bar - yellow or yellow with brown stripes (removable skin revealing white or black core pipe). - between 2 to 7 bar - orange. Steel pipes may have yellow wrap or black tar coating or no coating. Ductile iron may have plastic wrapping. Asbestos & Pl. Spun Cast iron No distinguishable colour				
Water non Potable & Grey Water	N/A	Black with green stripes	N/A	N/A	600 - 750mm	600 - 750mm
Water - Firefighting	N/A	Black with red stripes or bands	N/A	N/A	600 - 750mm	600 - 750mm
Oil / Fuel pipelines	N/A	Black	N/A	Various surface markers Marker tape or tiles above red concrete	900mm <i>All work within 3 metres of oil fuel pipelines must receive prior approval</i>	900mm <i>All work within 3 metres of oil fuel pipelines must receive prior approval</i>
Sewerage	Black	No distinguishing colour / material (eg Ductile iron may be red; PVC may be brown)	N/A	N/A	Variable	Variable
Communications	Grey, white, green, Black, Purple	N/A	Black or light grey	Various	250 - 350mm	450 - 600mm
Water	Blue or Grey	Blue polymer or blue or uncoated iron / GRP. Blue polymer with brown stripes (removable skin revealing white or black pipe)	N/A	Blue or Blue/black	750mm	750mm minimum
Water pipes for special purposes (e.g. contaminated ground)	N/A	Blue polymer with brown stripes (non-removable skin)	N/A	Blue or blue/black	750mm	750mm minimum

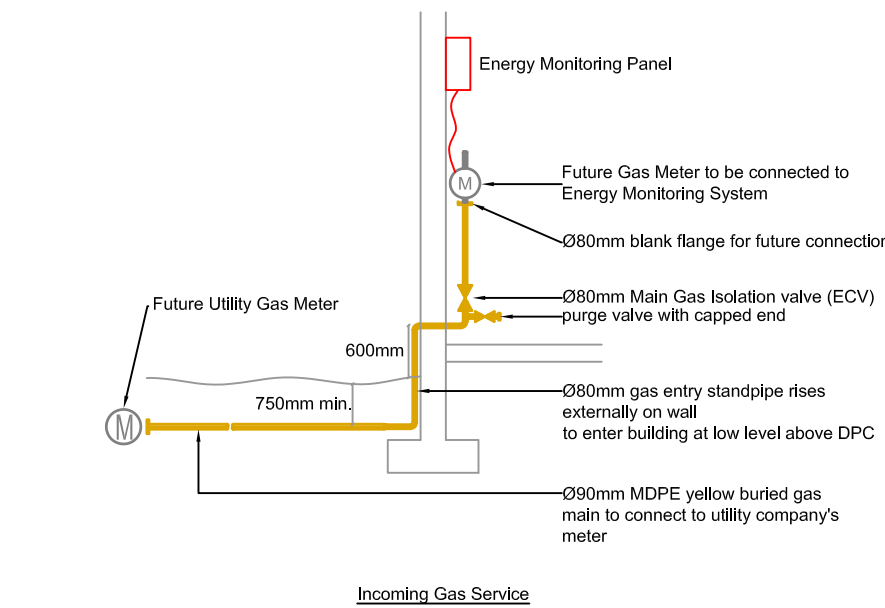
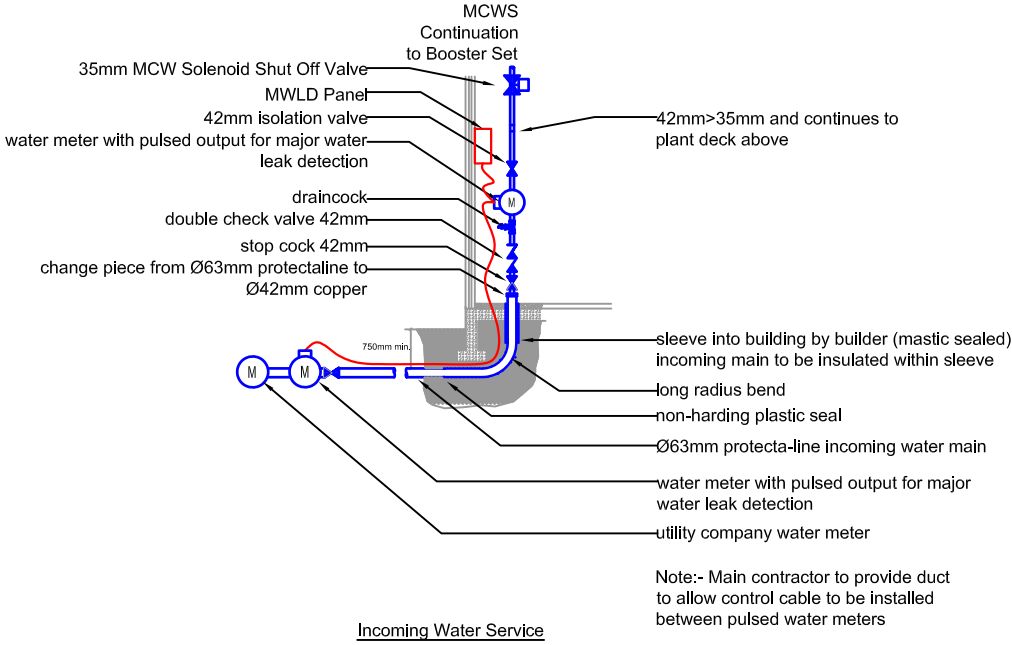
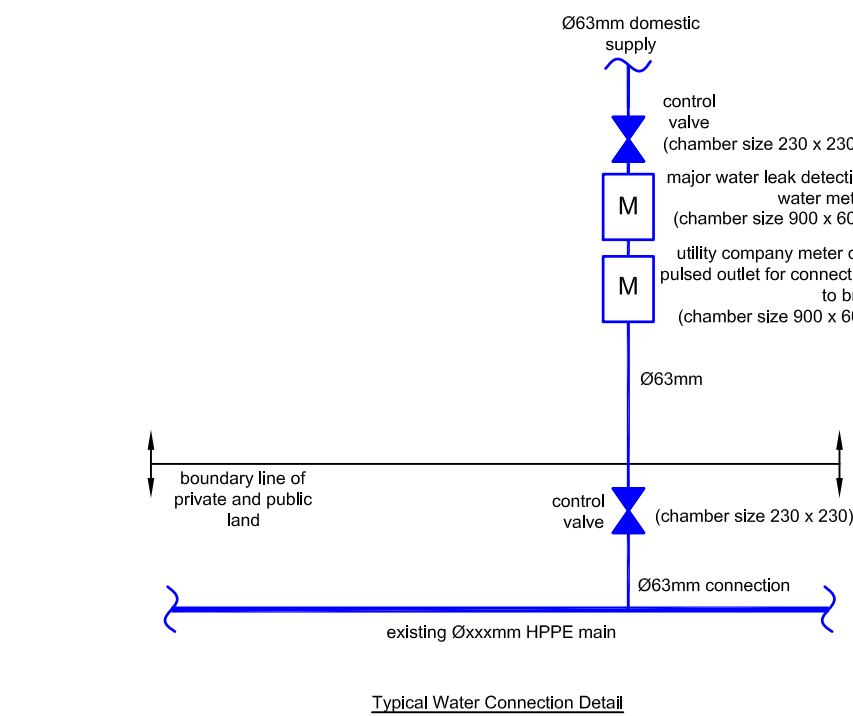

Existing hydrant location

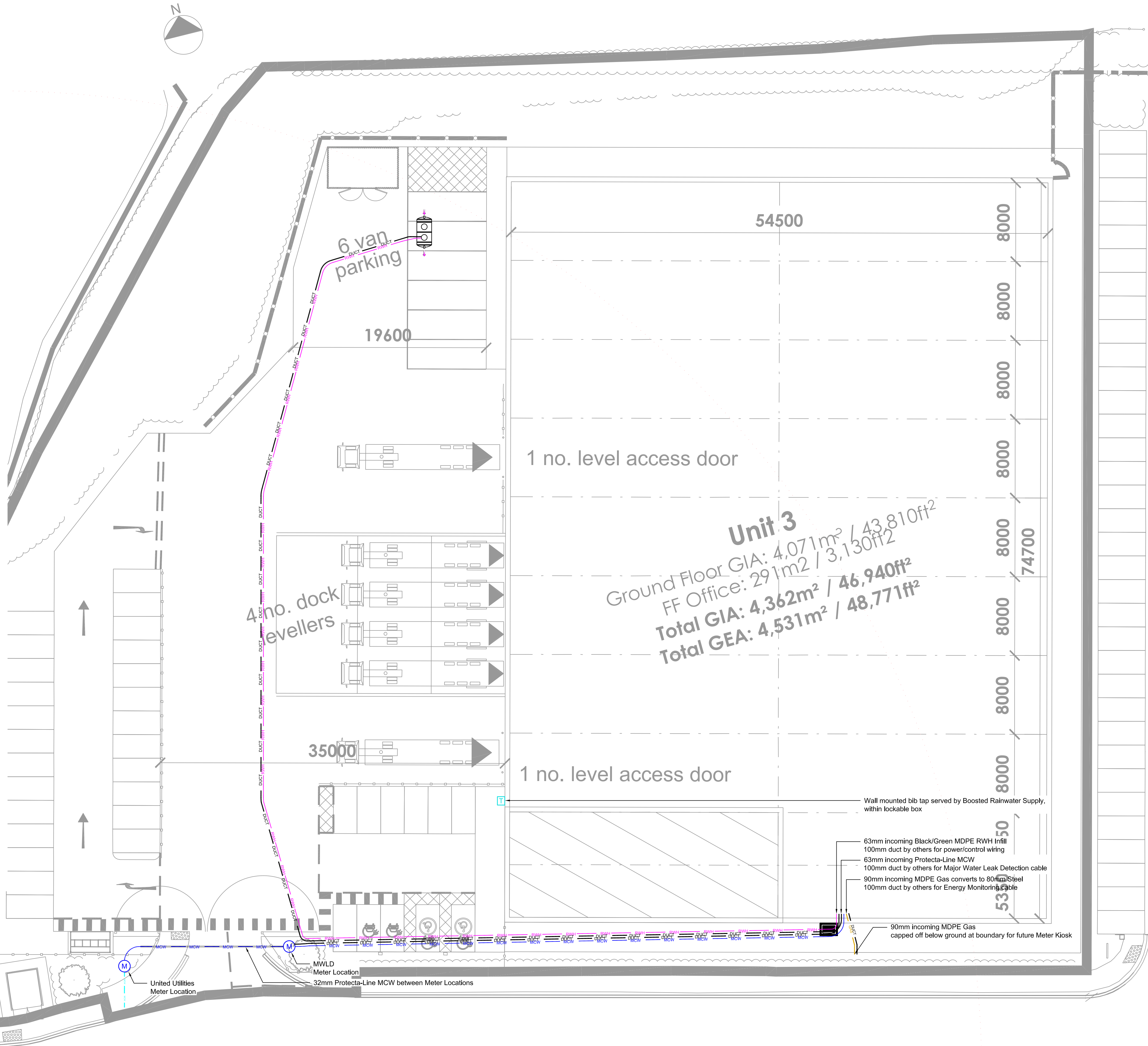

This drawing is the property of GAC Environmental Limited. Copyright is reserved by them and the drawing is issued on the condition that it is not copied, reproduced, retained or disclosed to any unauthorised person, either wholly or in part without the consent in writing of GAC Environmental Ltd.

NOTES:

- DO NOT SCALE THIS DRAWING.
- DO NOT ALTER BY HAND.
- THIS DRAWING IS TO BE READ IN CONJUNCTION WITH ALL OTHER RELEVANT DRAWINGS AND SPECIFICATIONS.
- ALL DIMENSIONS ARE IN MILLIMETRES UNLESS STATED OTHERWISE.

- UTILITY COMPANY WATER PIPE (BY OTHERS)
- MAINS COLD WATER SDR11 PROTECTA-LINE BARRIER PIPE
- HARVESTED RAINWATER SDR11 BLACK/GREEN MDPE PIPE
- 100mm DUCT BY OTHERS
- GAS SDR21 YELLOW MDPE PIPE
- METER
- ISOLATING VALVE
- NON-RETURN VALVE
- EXTERNAL BIB TAP
- EXISTING TYPE 2 HYDRANT

ALL EXTERNAL COLD WATER PIPE TO BE WRAPPED IN SPIRAL WRAP MARKER TAPE IN ACCORDANCE WITH UNITED UTILITIES GUIDANCE & BS1710.

AI	As Installed	JSH	29.04.24
Rev:	Amendments	By	Date

Drawing Status:	External References:
As Installed	

**GAC**  
Building Services Engineers

Chancel House  
East Street  
Bingham  
Nottingham NG13 8DS  
Tel: 01949 637 531  
Email: info@gac-environmental.com

Clients:

**winvic**

Project:  
Unit 3 Wingates Bolton  
Great Bank Road  
Westhoughton, Bolton  
BL5 3XN

Title:  
External Services

Drawn By: JSH	Engineer: DPM	Rec Copy Chk: -
Primary Scale: 1:200	Size: A1	Date Created: Apr 2024
Drawing Number: P23012-GAC-EX-XX-DR-M-7000	Revised:	



LEGEND OF EXTERNAL LIGHTING SYMBOLS	
SYMBOL	DESCRIPTION
	6m EXTERNAL LIGHTING COLUMN

LEGEND OF POWER SYMBOLS	
SYMBOL	DESCRIPTION
	ELECTRIC VEHICLE CHARGER

LEGEND OF EXTERNAL DUCT SYMBOLS	
SYMBOL	DESCRIPTION
	SPARE DUCT
	BT DUCT (BT SPECIFICATION)
	LV DUCT
	LV LIGHTING DUCT
	ELV DUCT
	EVC DUCT
	ALTERNATIVE COMMS/DATA DUCT
	DRAW PIT (600mm x 600mm)
	DRAW PIT (900mm x 900mm)
	DRAW PIT (1000mm x 1000mm)
	BT PIT - EXACT DETAILS TBC BY BT

LEGEND OF SMALL POWER & DATA SYMBOLS	
SYMBOL	DESCRIPTION
	NEW TPN DISTRIBUTION BOARD

NOTES

- DO NOT SCALE FROM THE DRAWING.
- ALL HV / LV CABLE DUCTS ARE TO HAVE SLOW RADIUS BENDS.
- ALL DUCTS ARE TO BE LEFT WITH DRAW CORDS FOR EASE OF FUTURE CABLE PULLING.
- ALL DUCTS AND BELOW GROUND SERVICES ARE TO BE INSTALL IN ACCORDANCE WITH THE NJUG STANDARD DEPTHS.
- ALL DRAW PITS ARE TO BE HEAVY DUTY TYPE TO WITHSTAND THE ASSOCIATED VEHICLE TRAFFIC, DEPENDING UPON AREA.
- ALL EXTERNAL LIGHTING COLUMNS TO BE PROVIDED WITH PRE-FORMED DEMOUNTABLE POLE CHAMBER SYSTEMS WHICH COMBINE COLUMN CHAMBER AND CABLE CHAMBER FOR EASE OF WIRING AND MAINTENANCE.
- ALL BT DUCTING AND CHAMBERS TO BE INSTALLED TO BT SPECIFICATION AND STANDARDS.
- ALL HV / LV CABLES ARE PROVIDED WITH THE NECESSARY WARNING MARKER TAPES.
- ALL BELOW GROUND DUCTING IS TWIN WALL TYPE COMPLETE WITH SMOOTH INTERIOR.

2

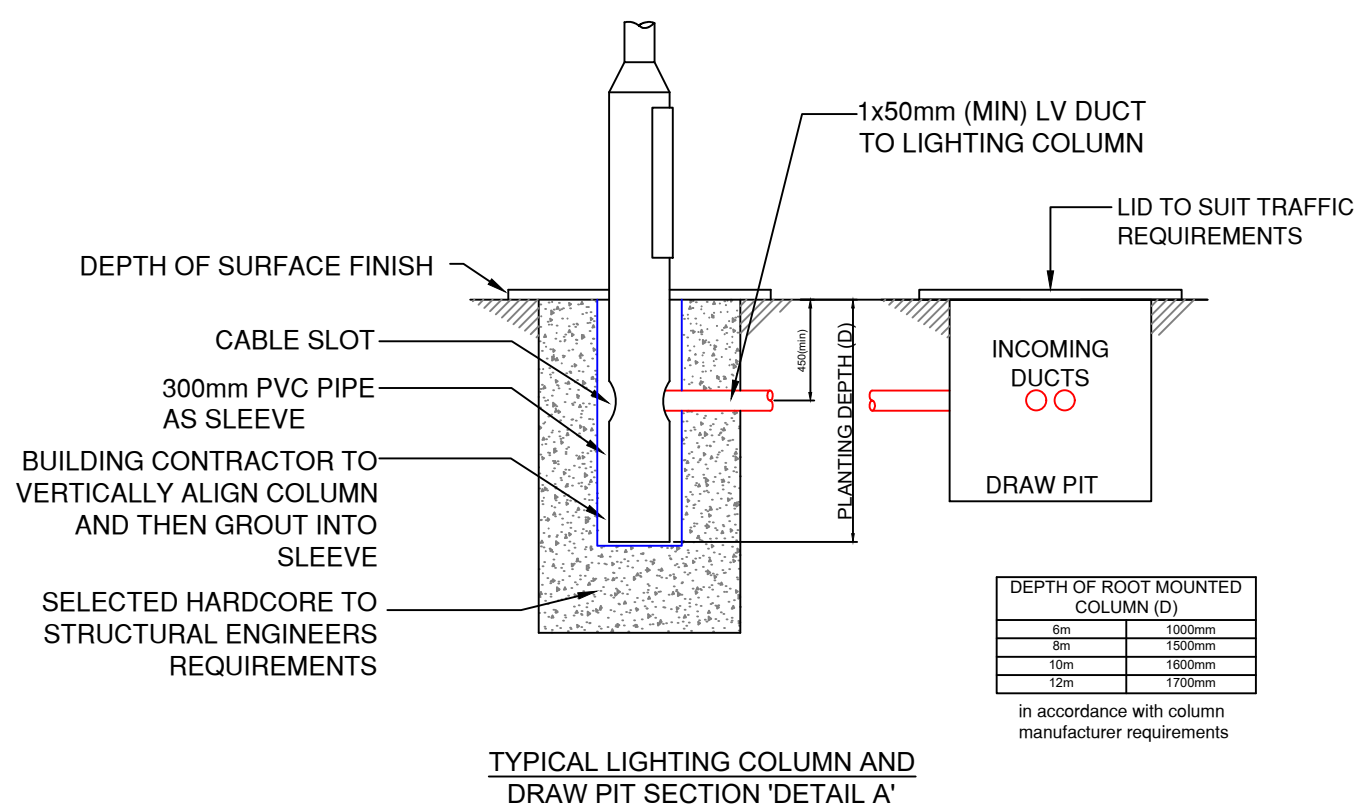
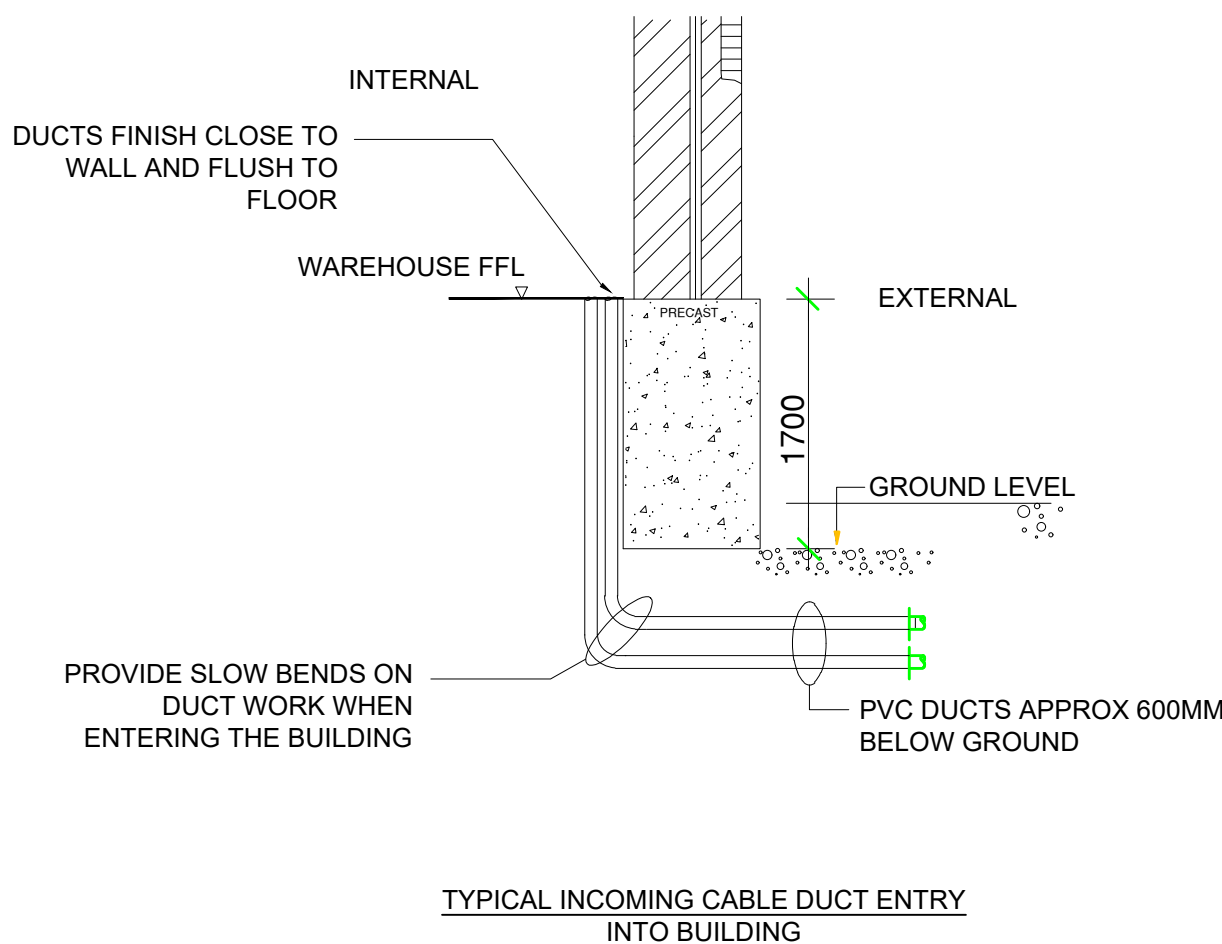
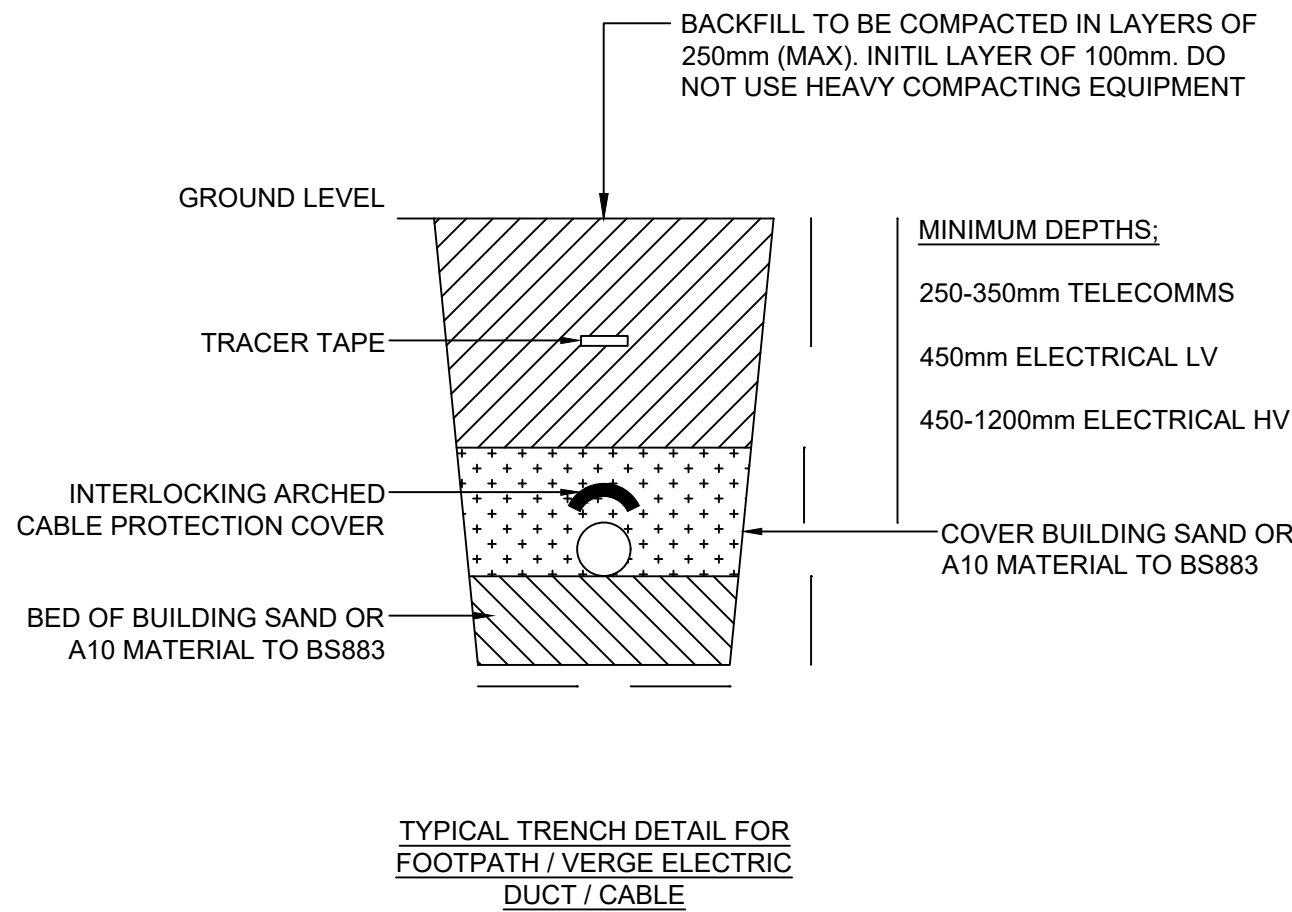
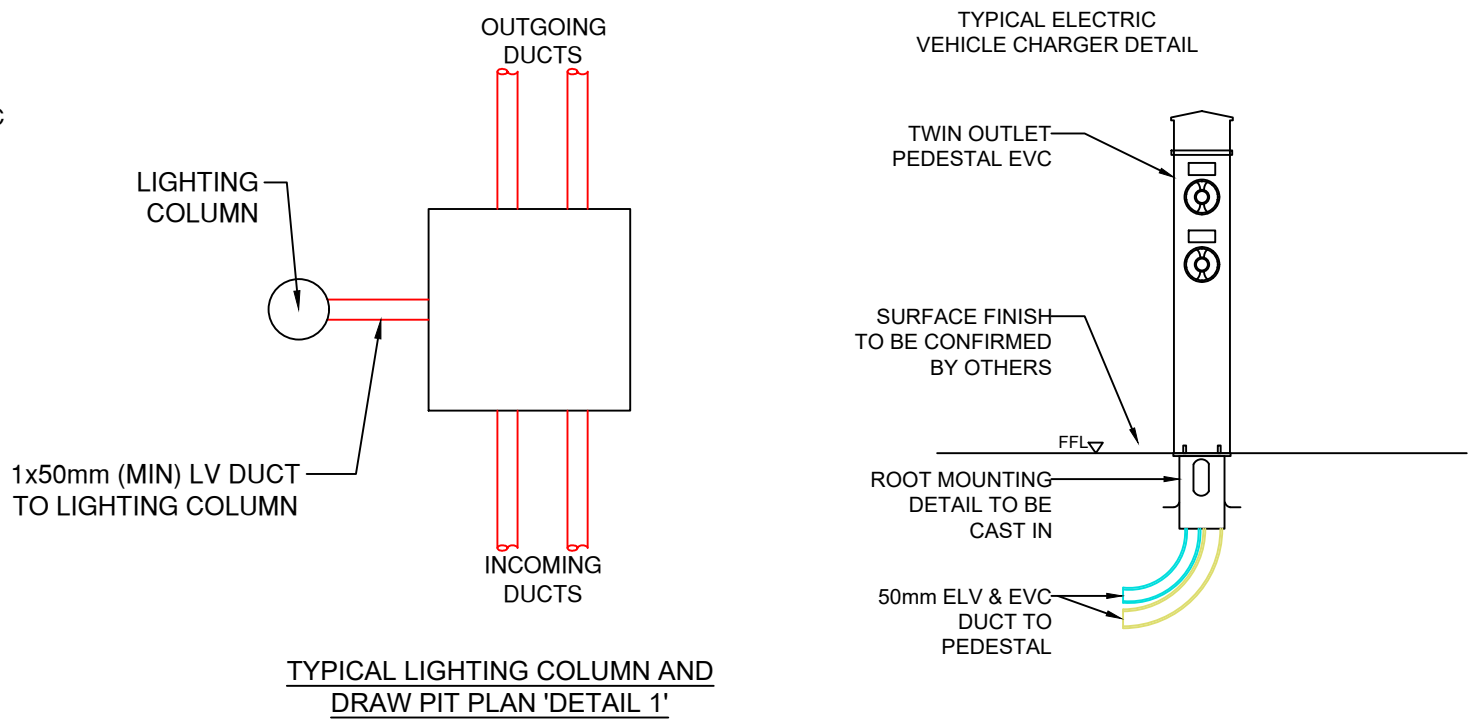

AF	AS FITTED	LH	21/05/2024
Rev.	Description	By	Date

AS FITTED



Project UNIT 3 WINGATES, BOLTON

Title UNIT 3 EXTERNAL SERVICES LAYOUT

Scale 1:500 Drg. Size A1 Date 16.10.2023

Drawn LH Checked TW Approved XX

Drg. No. P23012-EBM-EX-XX-DR-E-0930 Rev. AF

THIS DRAWING IS COPYRIGHT AND MAY NOT BE REPRODUCED EITHER IN PART OR FULL WITHOUT WRITTEN PERMISSION FROM EBM ELECTRICAL LTD



TABLE 1 - Recommended Colour Coding of Underground Utilities Apparatus  
All depths are from the surface level to the crown of the apparatus

Utility	Duct	Pipe	Cable	Marker Systems	Recommended Minimum Depths	Carriageway
					Footpath/Verge	750-1200mm
Electricity HV (High Voltage)	Black or red duct or tile	N/A	Red or black	Yellow with black and red legend or concrete tiles	450mm	600mm
Electricity LV (Low Voltage)	Black or red duct or tile	N/A	Black or red	Yellow with black legend	600mm footpath 750mm verge	750mm
Gas	Yellow	*** See row below	N/A	Black legend on PE pipes every 100mm	600mm footpath 750mm verge	750mm
*** PE - up to 2 bar - yellow or yellow with brown stripes (removable skin revealing white or black core pipe) - between 2 to 7 bar - orange Steel pipes may have yellow wrap or black tar coating or no coating. Ductile iron may have plastic wrapping. Asbestos & Pit / Spun Cast Iron No distinguishable colour						
Water non Potable & Grey Water	N/A	Black with green stripes	N/A	N/A	600 - 750mm	600 - 750mm
Water - Firefighting	N/A	Black with red stripes or bands	N/A	N/A	600 - 750mm	600 - 750mm
Oil / Fuel pipelines	N/A	Black	N/A	Various surface markers Marker tape or tiles above red concrete	900mm All work within 3 metres of oil fuel pipelines must receive prior approval	900mm All work within 3 metres of oil fuel pipelines must receive prior approval
Sewerage	Black	No distinguishing colour / material (eg. Ductile iron may be red, PVC may be brown)	N/A	N/A	Variable	Variable
Communications	Grey, white, green, Black, purple	N/A	Black or light grey	Various	250 - 350mm	450 - 600mm
Water	Blue or Grey	Blue polymer or blue or uncoated iron / GRP. Blue polymer with brown stripe (removable skin revealing white or black pipe)	N/A	Blue or Blue/black	750mm	750mm minimum
Water pipes for special purposes (e.g. contaminated ground)	N/A	Blue polymer with brown stripes (non-removable skin)	N/A	Blue or blue/black	750mm	750mm minimum

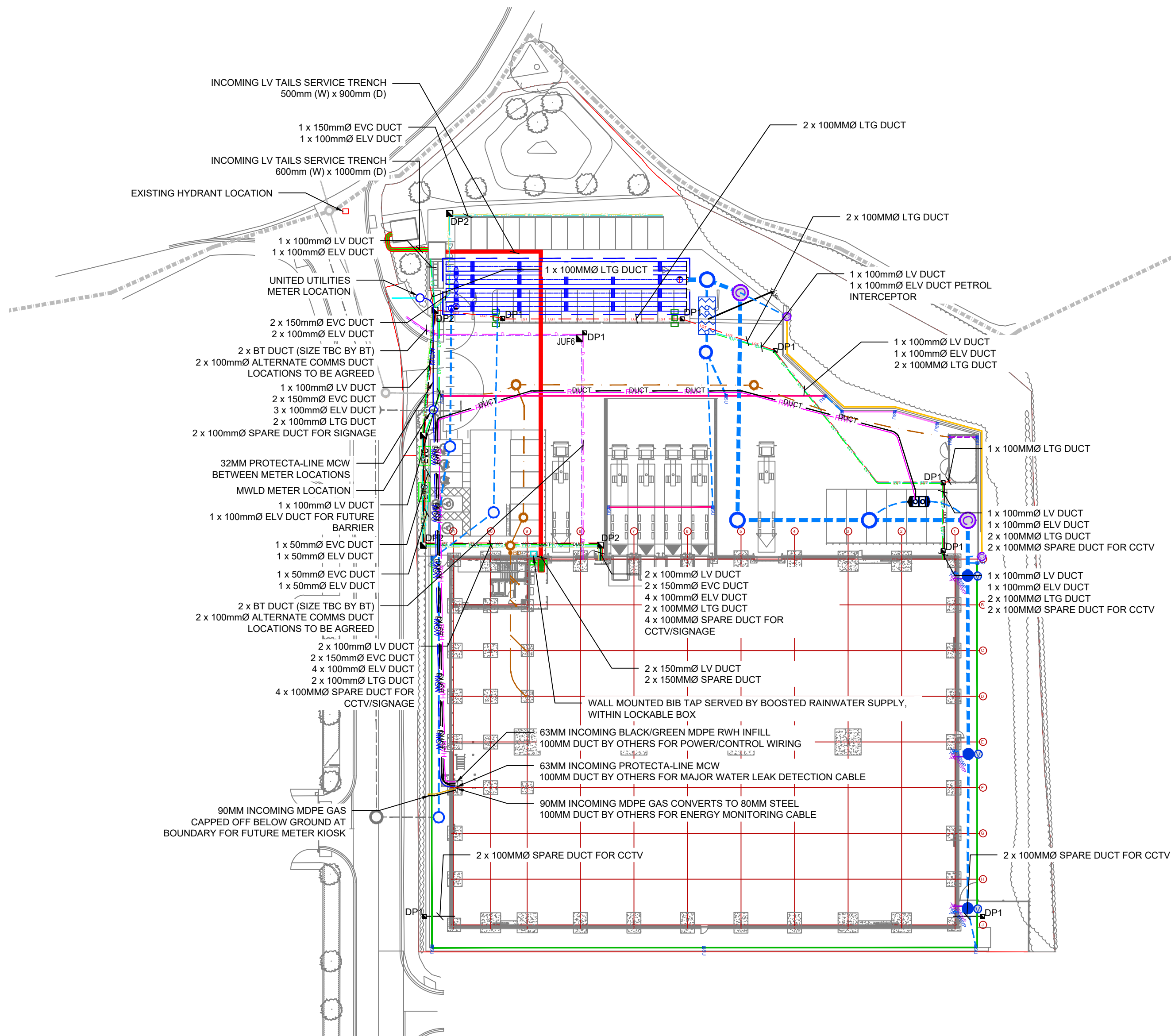

LEGEND OF EXTERNAL LIGHTING SYMBOLS	
SYMBOL	DESCRIPTION
	6m EXTERNAL LIGHTING COLUMN

LEGEND OF POWER SYMBOLS	
SYMBOL	DESCRIPTION
	ELECTRIC VEHICLE CHARGER

LEGEND OF EXTERNAL DUCT SYMBOLS	
SYMBOL	DESCRIPTION
	SPARE DUCT
	BT DUCT (BT SPECIFICATION)
	LV DUCT
	LV LIGHTING DUCT
	ELV DUCT
	EVC DUCT
	ALTERNATIVE COMMS/DATA DUCT
	EXTERNAL MAINS COLD WATER
	EXTERNAL GAS PIPEWORK
	EXTERNAL SPRINKLER PIPEWORK
	EXTERNAL RAINWATER PIPEWORK
	EXTERNAL DUCT (1000 & 1500)
	EXTERNAL BOOSTED COLD WATER
	DRAW PIT (600mm x 600mm)
	DRAW PIT (900mm x 900mm)
	DRAW PIT (1000mm x 1000mm)
	BT PIT - EXACT DETAILS TBC BY BT

LEGEND OF SMALL POWER & DATA SYMBOLS	
SYMBOL	DESCRIPTION
	NEW TPM DISTRIBUTION BOARD

NOTES

- DO NOT SCALE FROM THE DRAWING.
- ALL HV / LV CABLE DUCTS ARE TO HAVE SLOW RADIUS BENDS.
- ALL DUCTS ARE TO BE LEFT WITH DRAW CORDS FOR EASE OF FUTURE CABLE PULLING.
- ALL DUCTS AND BELOW GROUND SERVICES ARE TO BE INSTALL IN ACCORDANCE WITH THE NIJUG STANDARD DEPTHS.
- ALL DRAW PITS ARE TO BE HEAVY DUTY TYPE TO WITHSTAND THE ASSOCIATED VEHICLE TRAFFIC, DEPENDING UPON AREA.
- ALL EXTERNAL LIGHTING COLUMNS TO BE PROVIDED WITH PRE-FORMED DEMOUNTABLE POLE CHAMBER SYSTEMS WHICH COMBINE COLUMN CHAMBER AND CABLE CHAMBER FOR EASE OF WIRING AND MAINTENANCE.
- ALL BT DUCTING AND CHAMBERS TO BE INSTALLED TO BT SPECIFICATION AND STANDARDS.
- ALL HV / LV CABLES ARE PROVIDED WITH THE NECESSARY WARNING MARKER TAPES.
- ALL BELOW GROUND DUCTING IS TWIN WALL TYPE COMPLETE WITH SMOOTH INTERIOR.

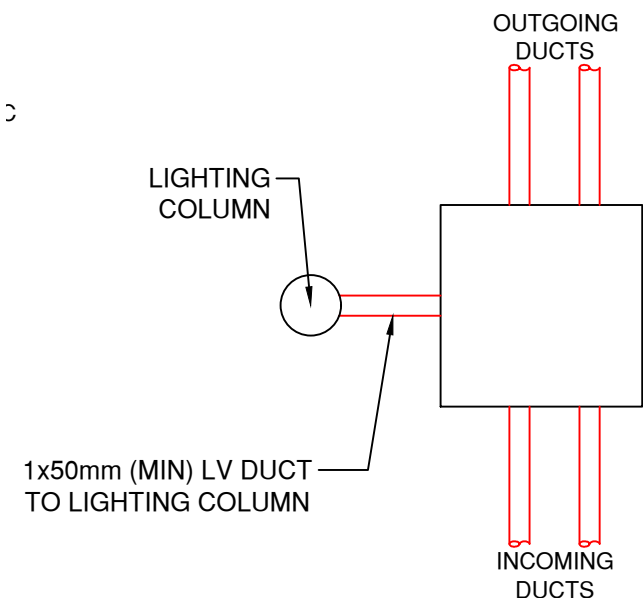
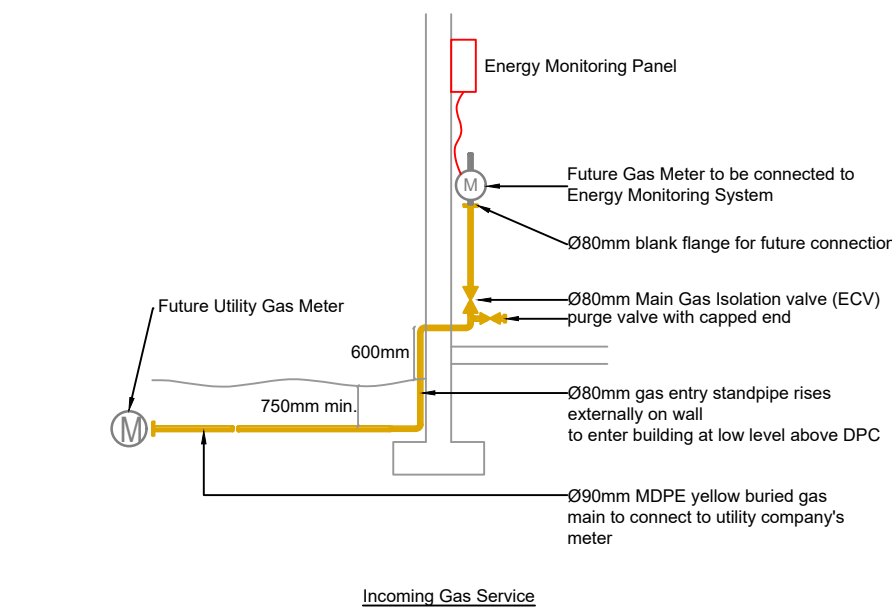
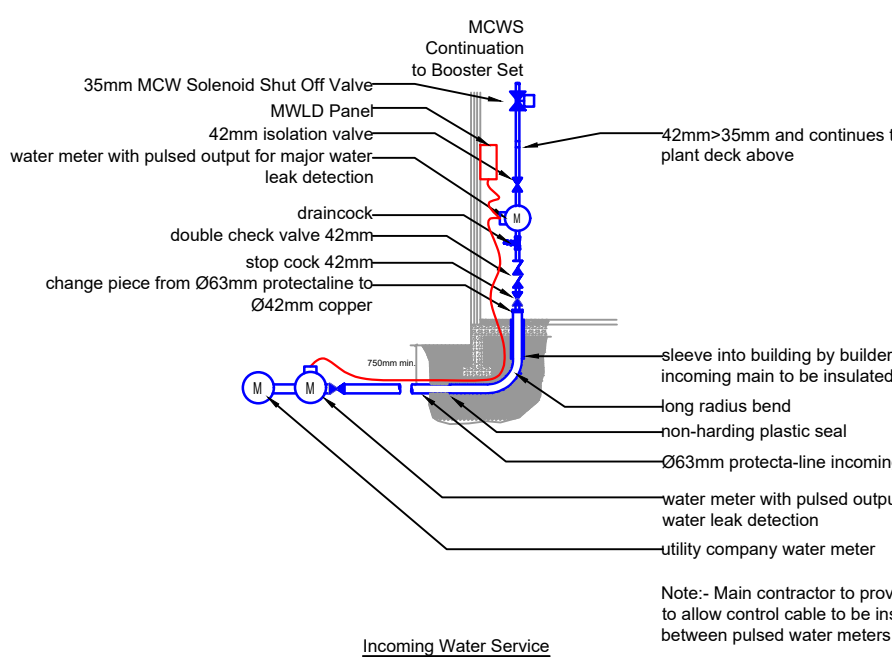
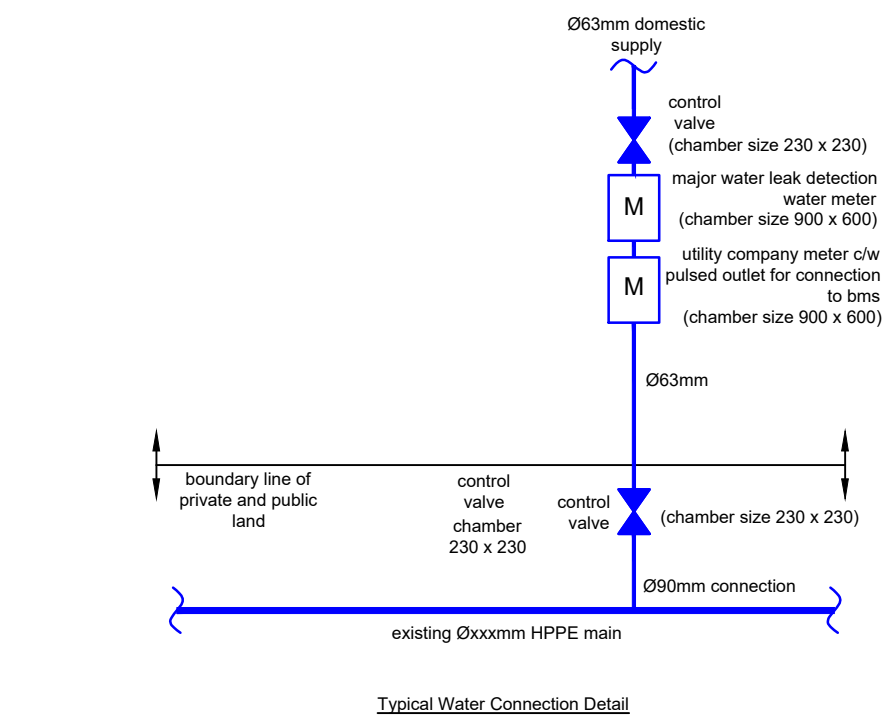

TYPICAL LIGHTING COLUMN AND DRAW PIT PLAN 'DETAIL 1'

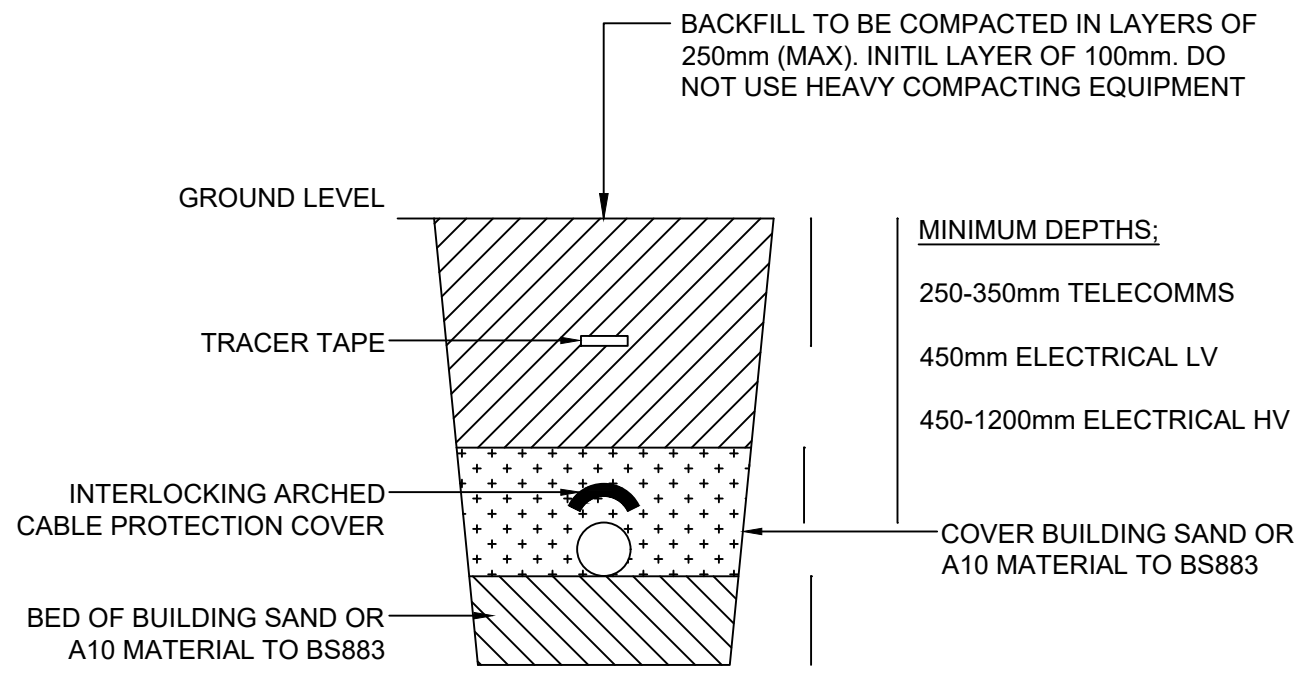

TYPICAL TRENCH DETAIL FOR FOOTPATH / VERGE ELECTRICAL DUCT / CABLE

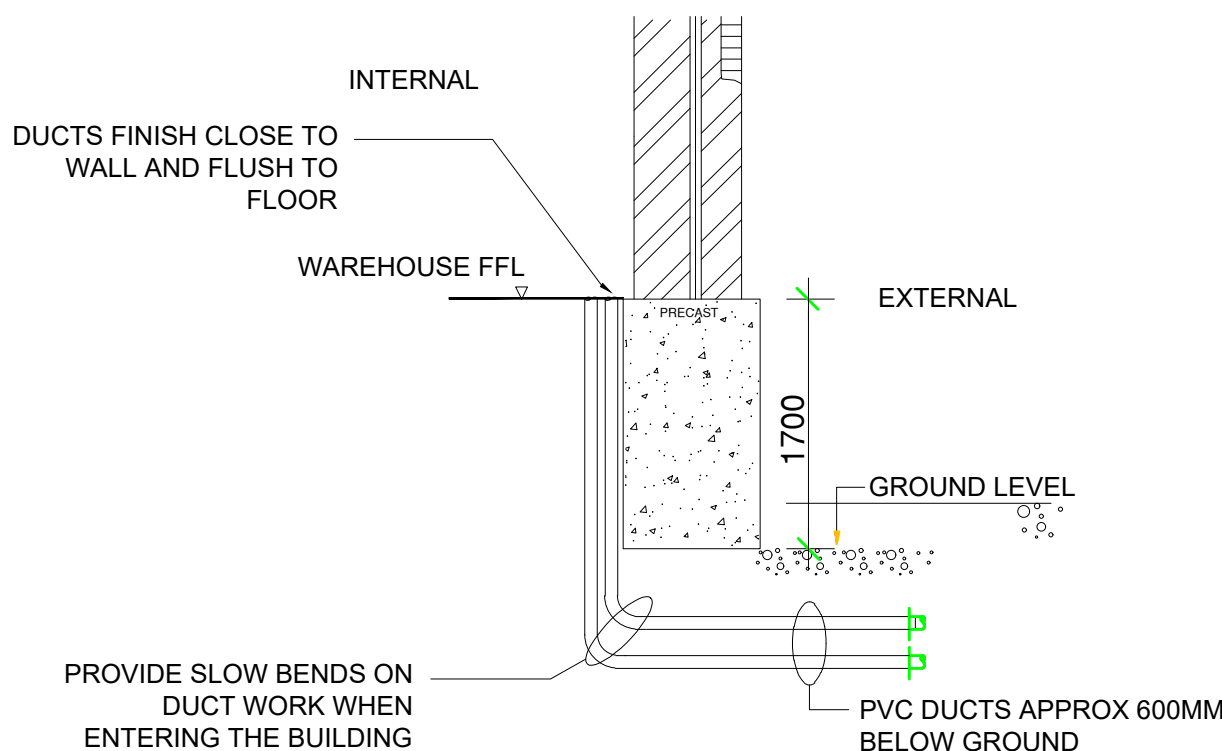

TYPICAL INCOMING CABLE DUCT ENTRY INTO BUILDING

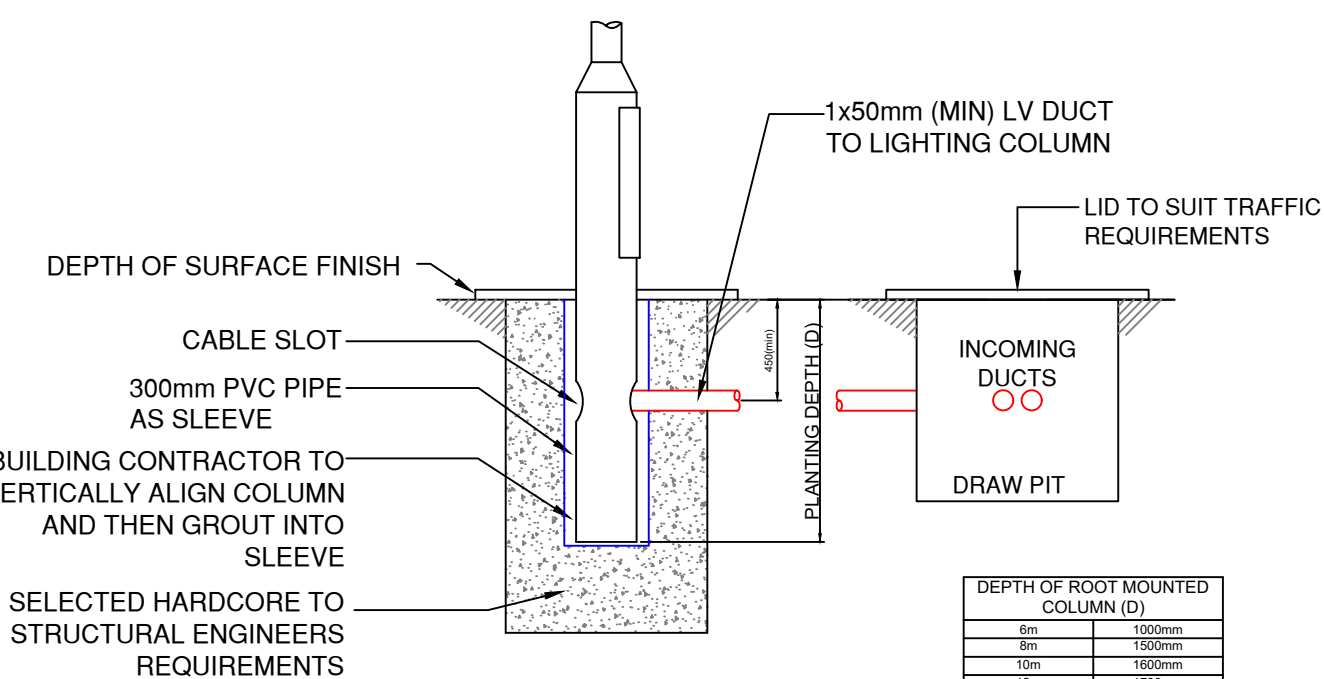

TYPICAL LIGHTING COLUMN AND DRAW PIT SECTION 'DETAIL A'

DEPTH OF ROOT MOUNTED COLUMN (D)	
6m	1000mm
8m	1200mm
10m	1400mm
12m	1600mm

in accordance with column manufacturer requirements



AF	AS FITTED.	LH	21/05/2024
Rev.	Description	By	Date

AS FITTED



Project UNIT 3 WINGATES, BOLTON

Title UNIT 3 COMBINED M&E EXTERNAL SERVICES LAYOUT

Scale 1:500 Drg. Size A1 Date 16.10.2023

Drawn LH Checked TW Approved XX

Drg. No. P23012-EBM-EX-XX-DR-E-0935 Rev. AF